

45mm PMMA Rgb Led Spotlight Lens 10 Degree

Model:	AJS45DRGBW10G
Size:	Ø45mm
Height:	26.1mm
Beam Angle:	10°
Material:	PMMA
Transmittance:	>93%
LED Type:	CREE XML-RGBW



FEATURES

- 1, RGBW lenses are commonly used in lighting applications such as stage lighting, building facade lighting, and interior lighting.
- 2, By controlling the brightness and mixing ratio of LED lights of different colors, various color light effects can be achieved. Red, green, and blue LEDs can be mixed to produce various colored lights, while white LEDs can provide brighter overall lighting.
- 3, RGBW lenses find application in entertainment venues such as clubs, bars, and dance floors. These lenses enable lighting designers to create immersive lighting experiences, incorporating vibrant colors, moving patterns, and dynamic effects that synchronize with the music and atmosphere.



LENS LIGHT DISTRIBUTION & APPLICATION



LENS DRAWING

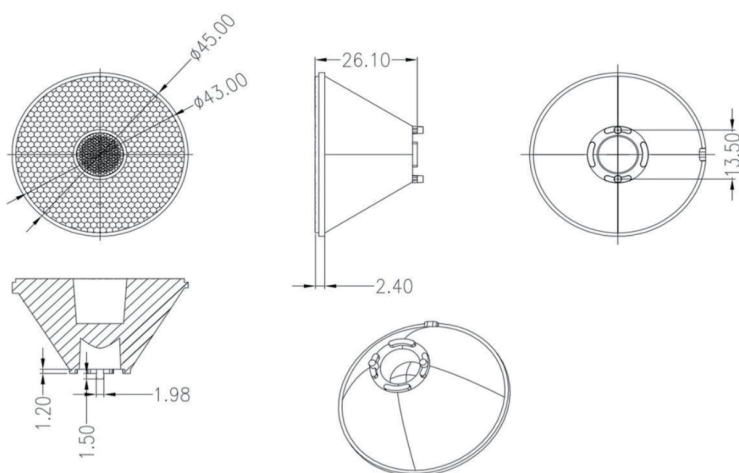

LED TYPE



CREE XML-RGBW



CREE XML-RGBW

LED BRAND

